

GENERAL INFORMATION

PIPER PA 28 SERIES

PASSENGER BRIEFING

FAA Regulation requires the Pilot in Command to brief all passengers on the following items prior to each takeoff. This card has been prepared to supplement the Pilot's passenger briefing.

SEAT BACKS

Seat backs must be secured in the upright position during takeoff and landing.

SEAT ADJUSTMENTS

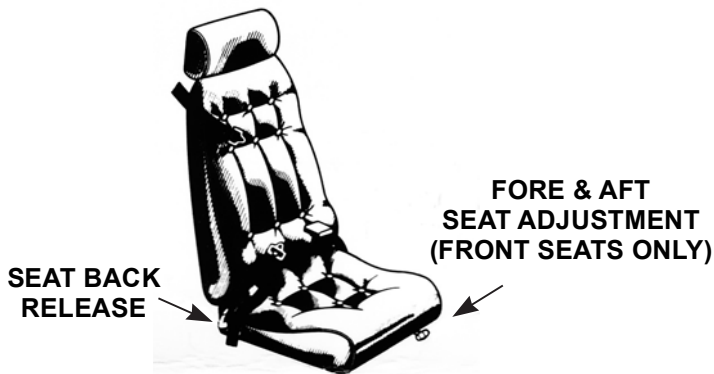

FASTEN SEAT BELTS NO SMOKING

Fasten seat belt & shoulder harness (if present) for take off & landing. Insert latch into buckle & pull belt snug. To release belt, pull up on lip of buckle. Smoking is **not permitted** onboard the aircraft at any stage of the flight.

FIRST AID KIT

A First Aid kit is located behind the Pilot's seat in the seat back in case of emergency.

FIRE EXTINGUISHER

A Fire Extinguisher is located either in front of the Pilot's seat or between the two front seats on the floor.

The Pilot's Operating Handbook shall be the authority if an inconsistency exists between this card and the Pilot's Operating Handbook.

EMERGENCY INFORMATION

PIPER PA 28 SERIES

EMERGENCY EXIT

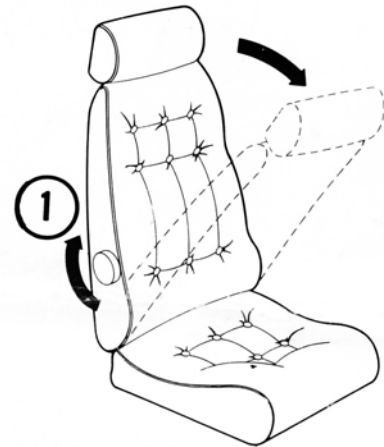
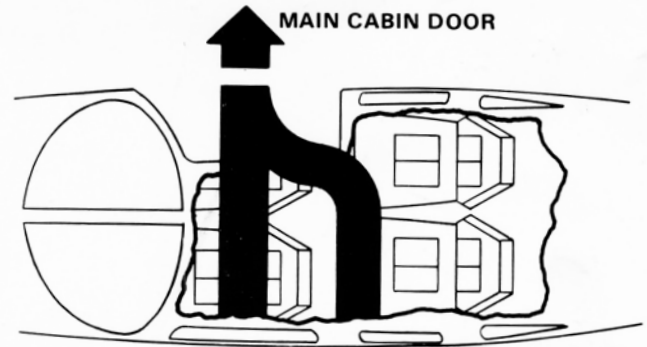

To tilt seat forward, turn knob (1) clockwise, push seat forward (right front seat only).

MAIN CABIN DOOR OPERATION

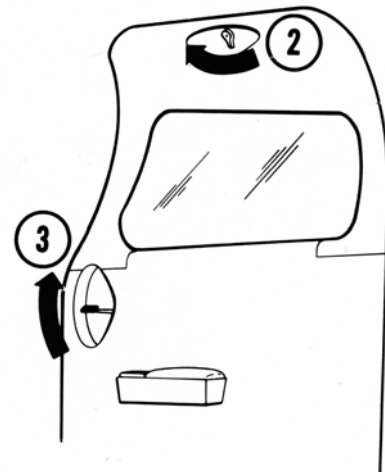

To open cabin door, twist upper door latch (2) forward lift the lower latch (3) up. Push door open.